

R-VENT[®] Hulpstukken

R-Vent Hulpstukken worden standaard uitgevoerd in sendzimir verzinkt staal. Daarnaast kunnen R-Vent Hulpstukken geleverd worden in aluminium, roestvaststaal of voorzien worden van een kunststof PU-coating.

Luchtdichtheidsklasse C conform Luka

De toelaatbare hoeveelheid leklucht wordt gerelateerd aan de klassen van luchtdichtheid, waarvoor een toetsingsdruk geldt, die ontleend is aan NEN-EN 12237. De productie van R-Vent Hulpstukken wordt gecontroleerd en gegarandeerd volgens luchtdichtheidsklasse C zoals gedefinieerd door de Nederlandse Vereniging van Luchtkanalenfabrikanten (Luka).

Door TÜV Rheinland Nederland B.V. te Apeldoorn zijn al onze gangbare diameters hulpstukken op luchtdichtheid getest. Voor vragen en een kopie van het TÜV Rheinland Nederland B.V. Productlabel waarin deze garantie wordt afgegeven kunt u contact opnemen met onze verkoopafdeling.

Luka

Nederlandse Vereniging van
Luchtkanalenfabrikanten

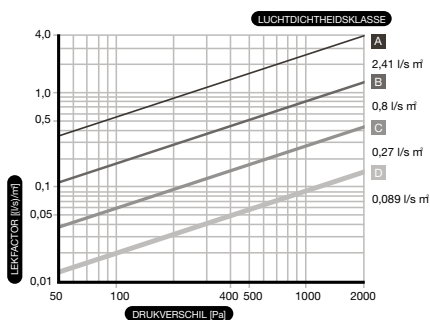

1

R-Vent Sendzimir verzinkte gladde- en segmentbochten 1-21

R-Vent Sendzimir verzinkte plooibochten 1-22

R-Vent Sendzimir verzinkte centrische T-stukken 90° 1-23

R-Vent Sendzimir verzinkte centrische zadelstukken 90° 1-24

2

R-Vent Sendzimir verzinkte geperste T-stukken 90° 1-25

R-Vent Sendzimir verzinkte geperste kruisstukken 90° 1-26

R-Vent Sendzimir verzinkte centrische T-stukken 45° 1-27

R-Vent Sendzimir verzinkte broekstukken 45° en 22,5° 1-28

3

R-Vent Sendzimir verzinkte geperste zadelstukken 90° 1-29

R-Vent Sendzimir verzinkte zadelstukken 45° 1-30

R-Vent Sendzimir verzinkte centrische verloopstukken 1-31

R-Vent Sendzimir verzinkte overige hulpstukken 1-33

4**5****6****7****8****9****10****11****12**

Bochten SBD

Voorbeeld artikelnr.:
SBD006390

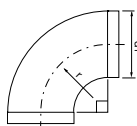

90°

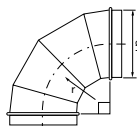

60°

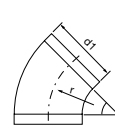
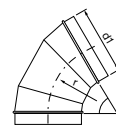
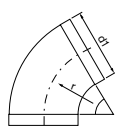

45°

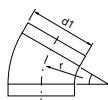

30°

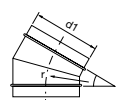

15°

Voorbeeld artikelnr.:
SBSD008090

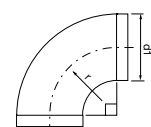

Type SBSD R= 1,5 x D

| ø d1 (mm) | Type SBD, R= 1 x D | | | | | Type SBSD, R= 1,5 x D | | |
|--------------|--------------------|--------|--------|--------|--------|-----------------------|-------|--|
| | 90° | 60° | 45° | 30° | 15° | | 90° | |
| 63 | 10,80 | 12,29 | 10,18 | 11,82 | 12,79 | | | |
| 80 | 7,24 | 9,56 | 6,48 | 7,33 | 7,99 | | 14,18 | |
| 100 | 7,02 | 7,99 | 6,12 | 7,10 | 7,68 | | 16,65 | |
| 125 | 9,08 | 10,41 | 7,10 | 8,05 | 8,73 | | 52,19 | |
| 140 | 12,84 | 16,93 | 9,48 | 10,77 | 12,29 | | | |
| 150 | 12,76 | 14,55 | 9,48 | 10,77 | 11,69 | | 21,42 | |
| 160 | 12,79 | 14,62 | 9,43 | 10,71 | 11,66 | | 30,15 | |
| 180 | 17,35 | 19,82 | 12,16 | 13,49 | 14,62 | | 67,39 | |
| 200 | 19,07 | 21,69 | 12,92 | 15,02 | 16,25 | | 90,76 | |
| 224 | 26,81 | 32,85 | 20,05 | 34,02 | 23,99 | | 69,43 | |
| 250 | 29,11 | 39,90 | 18,60 | 19,65 | 21,57 | | 73,25 | |
| 280 | 32,95 | 35,56 | 23,55 | 24,07 | 25,27 | | 82,69 | |
| 300 | 34,96 | 37,68 | 24,45 | 23,69 | 25,78 | | 95,18 | |
| 315 | 38,11 | 39,20 | 27,24 | 26,78 | 29,22 | | 93,62 | |
| 355 | 47,44 | 51,18 | 35,91 | 35,96 | 39,25 | | | |
| 400 | 61,94 | 66,15 | 41,01 | 40,56 | 44,32 | | | |
| 450 | 65,20 | 67,63 | 45,65 | 43,26 | 44,32 | | | |
| 500 | 72,74 | 69,04 | 49,77 | 43,11 | 47,44 | | | |
| 560 | 89,73 | 95,18 | 61,52 | 53,05 | 58,22 | | | |
| 600 | 125,59 | 120,92 | 75,55 | 60,54 | 66,15 | | | |
| 630 | 115,45 | 129,49 | 79,58 | 79,58 | 88,15 | | | |
| 710 | 190,34 | 205,94 | 145,88 | 99,86 | 108,43 | | | |
| 800 | 237,15 | 255,09 | 165,38 | 121,70 | 132,62 | | | |
| 900 | 431,29 | 439,98 | 269,12 | 201,26 | 224,68 | | | |
| 1000 | 500,05 | 539,83 | 289,92 | 244,17 | 267,57 | | | |
| 1120 | 695,07 | 748,89 | 407,21 | 320,62 | 351,04 | | | |
| 1250 | 747,34 | 801,16 | 502,39 | 352,61 | 383,82 | | | |

| ø d1 (mm) | Gladde bocht type SGBD R=D | | | |
|--------------|----------------------------|-------|-------|-------|
| | 90° | 60° | 45° | 30° |
| 250 | 29,11 | 39,90 | 18,60 | 19,65 |

t/m Ø224 mm gladde bochten.

Ø250 kan uitgevoerd worden in gladde uitvoering type SGBD (behalve 15°) en segment uitvoering type SBD. Vanaf Ø250 mm worden segmentbochten geleverd.

Vet cursief gedrukte diameters zijn aanbevolen en toegevoegde NEN-EN 1506 diameters en veelal voorradig.



Bochten SPLB

Voorbeeld artikelnr.:
SPLB08090

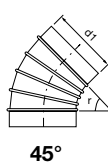
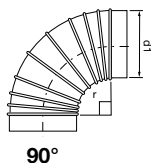

| ø d1 (mm) | Type SPLB, R= 1 x D | |
|--------------|------------------------|-------|
| | 90° | 45° |
| <i>80</i> | 4,49 | 3,08 |
| <i>100</i> | 4,68 | 3,28 |
| <i>125</i> | 4,73 | 3,63 |
| <i>150</i> | 7,49 | 4,76 |
| <i>150</i> | 10,10 | 7,68 |
| 180 | 11,98 | 11,98 |
| 200 | 11,98 | 11,98 |

Vet cursief gedrukte diameters zijn aanbevolen en toegevoegde NEN-EN 1506 diameters en veelal voorradig.

R-VENT® Sendzimir verzinkte centrische T-stukken 90°

Artikelgroep 10

T-stuk STCD

Voorbeeld artikelnr.:
STCD00630063

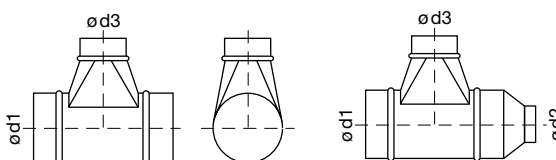

Prijssamenstelling

Verlopende T-stukken: prijs STCD + prijs SRCLD + 30%.

Excentrische T-stukken: prijs STCD + 50%.

Voorbeeld artikelnr.: STCR012010012

Voorbeeld artikelnr.: STD01000100

| ø d1 (mm) | ø d3 | | | | | | | | | | | | | | |
|--------------|-------|-------|-------|-------|-------|-------|--------|--------|--------|--------|--------|--------|--------|--------|--------|
| | 63 | 80 | 100 | 125 | 140 | 150 | 160 | 180 | 200 | 224 | 250 | 280 | 300 | 315 | |
| 63 | 21,53 | 21,80 | 22,66 | | | | | | | | | | | | |
| 80 | 22,66 | 24,38 | 23,13 | 24,11 | 28,20 | 28,20 | | | | | | | | | |
| 100 | 22,66 | 22,94 | 24,81 | 26,03 | 28,20 | 28,20 | 28,67 | 29,89 | 30,27 | 35,09 | | | | | |
| 125 | 23,13 | 23,13 | 24,81 | 26,78 | 28,44 | 28,67 | 29,36 | 30,27 | 30,98 | 35,81 | | | | | |
| 140 | 25,78 | 26,03 | 26,03 | 28,20 | 30,55 | 30,27 | 30,27 | 32,91 | 32,91 | 35,81 | 37,45 | 41,04 | 41,55 | | |
| 150 | 25,78 | 26,03 | 26,03 | 28,20 | 30,55 | 30,27 | 30,27 | 32,91 | 32,91 | 35,81 | 37,45 | 41,04 | 41,55 | | |
| 160 | 25,78 | 26,03 | 26,03 | 28,20 | 30,55 | 30,27 | 30,27 | 32,91 | 32,91 | 35,81 | 37,45 | 42,37 | 41,55 | | |
| 180 | 27,95 | 28,20 | 28,90 | 30,55 | 33,42 | 33,42 | 33,42 | 35,81 | 35,81 | 38,43 | 41,04 | 43,76 | 44,63 | | |
| 200 | 28,20 | 28,44 | 29,11 | 30,55 | 33,42 | 33,42 | 33,63 | 35,81 | 35,81 | 39,87 | 41,55 | 46,34 | 44,63 | 46,74 | |
| 224 | 29,89 | 30,86 | 32,24 | 33,20 | 35,39 | 35,56 | 35,81 | 38,68 | 39,87 | 42,98 | 42,68 | 46,84 | 48,39 | 50,20 | |
| 250 | 38,92 | 30,98 | 33,42 | 34,17 | 35,39 | 36,08 | 36,28 | 39,12 | 41,04 | 42,98 | 42,68 | 48,83 | 49,33 | 50,20 | |
| 280 | 31,53 | 34,66 | 35,39 | 36,28 | 39,12 | 39,63 | 39,87 | 44,63 | 44,86 | 46,74 | 47,44 | 50,70 | 50,70 | 51,66 | |
| 300 | 33,89 | 34,66 | 35,81 | 36,28 | 39,12 | 39,63 | 40,11 | 44,86 | 45,09 | 46,74 | 47,44 | 50,70 | 52,61 | 52,61 | |
| 315 | 33,89 | 34,86 | 36,28 | 37,45 | 39,63 | 39,87 | 41,04 | 45,09 | 47,44 | 48,83 | 48,83 | 51,66 | 52,61 | 52,61 | |
| 355 | 39,87 | 41,99 | 42,68 | 43,69 | 46,74 | 47,44 | 48,83 | 49,77 | 50,70 | 54,93 | 54,93 | 58,22 | 58,22 | 60,11 | |
| 400 | 44,08 | 46,74 | 42,68 | 45,87 | 48,83 | 49,77 | 49,77 | 56,33 | 54,02 | 59,16 | 58,71 | 63,86 | 63,39 | 63,39 | |
| 450 | 58,71 | 61,94 | 63,86 | 65,20 | 67,13 | 67,63 | 68,08 | 69,04 | 69,94 | 70,41 | 70,88 | 75,07 | 76,50 | 76,96 | |
| 500 | 58,71 | 61,94 | 63,86 | 65,20 | 67,13 | 67,63 | 68,08 | 69,04 | 69,94 | 71,86 | 72,26 | 75,55 | 77,46 | 76,96 | |
| 560 | 81,15 | 84,26 | 88,15 | 90,50 | 95,18 | 95,18 | 95,18 | 99,07 | 99,07 | 101,42 | 101,42 | 104,53 | 104,53 | 104,53 | |
| 600 | 81,15 | 84,26 | 88,15 | 90,50 | 95,18 | 95,18 | 95,18 | 99,07 | 99,07 | 101,42 | 101,42 | 104,53 | 104,53 | 104,53 | |
| 630 | 81,15 | 84,26 | 88,15 | 90,50 | 95,18 | 95,18 | 95,18 | 99,07 | 99,07 | 104,53 | 101,42 | 110,01 | 106,89 | 106,10 | |
| 710 | | | | | | | 152,90 | 153,69 | 153,69 | 153,69 | 158,36 | 159,14 | 173,98 | 173,98 | 173,98 |
| 800 | | | | | | | 152,90 | 153,69 | 153,69 | 153,69 | 158,36 | 159,14 | 173,98 | 173,98 | 173,98 |
| 900 | | | | | | | | | | 334,65 | 334,65 | 334,65 | 352,61 | 352,61 | 352,61 |
| 1000 | | | | | | | | | | 347,15 | 347,15 | 347,15 | 377,57 | 377,57 | 377,57 |
| 1120 | | | | | | | | | | | | | 555,44 | 555,44 | 555,44 |
| 1250 | | | | | | | | | | | | | 555,44 | 555,44 | 555,44 |

| ø d1 (mm) | ø d3 | | | | | | | | | | | | | |
|--------------|--------|--------|--------|--------|--------|--------|--------|--------|--------|--------|--------|---------|---------|--|
| | 355 | 400 | 450 | 500 | 560 | 600 | 630 | 710 | 800 | 900 | 1000 | 1120 | 1250 | |
| 200 | 50,20 | 53,56 | | | | | | | | | | | | |
| 224 | 56,33 | 58,22 | | | | | | | | | | | | |
| 250 | 54,40 | 59,60 | 65,20 | 74,61 | | | | | | | | | | |
| 280 | 55,89 | 61,52 | 71,86 | 82,69 | | | | | | | | | | |
| 300 | 56,82 | 61,94 | 72,74 | 84,26 | 100,63 | 113,12 | | | | | | | | |
| 315 | 61,94 | 62,92 | 75,55 | 85,81 | 100,63 | 113,89 | | | | | | | | |
| 355 | 69,04 | 69,04 | 78,79 | 90,50 | 107,66 | 129,49 | | | | | | | | |
| 400 | 69,04 | 70,41 | 85,81 | 95,18 | 118,57 | 137,30 | 166,94 | | | | | | | |
| 450 | 77,93 | 85,81 | 98,29 | 120,14 | 138,85 | 150,55 | 171,62 | 249,63 | | | | | | |
| 500 | 80,36 | 86,60 | 98,29 | 100,63 | 138,85 | 145,88 | 180,21 | 250,41 | 260,55 | | | | | |
| 560 | 111,55 | 115,45 | 127,94 | 127,94 | 197,35 | 197,35 | 197,35 | 251,20 | 260,55 | 330,76 | | | | |
| 600 | 111,55 | 115,45 | 127,94 | 134,18 | 197,35 | 197,35 | 202,04 | 251,20 | 271,48 | 302,69 | | | | |
| 630 | 124,03 | 124,03 | 131,06 | 138,85 | 197,35 | 196,58 | 202,04 | 251,20 | 278,50 | 278,50 | 373,68 | | | |
| 710 | 180,21 | 187,23 | 203,60 | 205,94 | 263,67 | 264,45 | 263,67 | 296,43 | 312,81 | 397,85 | 397,85 | 528,13 | | |
| 800 | 180,21 | 187,23 | 203,60 | 205,94 | 263,67 | 272,26 | 263,67 | 296,43 | 312,81 | 388,49 | 407,21 | 534,38 | 592,09 | |
| 900 | 365,09 | 400,97 | 432,17 | 432,17 | 520,33 | 520,33 | 520,33 | 577,28 | 577,28 | 642,04 | 642,04 | 826,92 | 826,92 | |
| 1000 | 387,72 | 400,97 | 432,17 | 443,10 | 520,33 | 557,77 | 534,38 | 577,28 | 581,18 | 642,04 | 660,75 | 826,92 | 830,81 | |
| 1120 | 555,44 | 555,44 | 555,44 | 583,51 | 681,03 | 720,03 | 649,06 | 691,97 | 713,02 | 811,31 | 811,31 | 1005,56 | 1005,56 | |
| 1250 | 555,44 | 555,44 | 555,44 | 604,58 | 617,83 | 720,03 | 637,33 | 694,28 | 748,11 | 811,31 | 830,03 | 1028,17 | 1046,12 | |

Zadelstuk STSTCD

Voorbeeld artikelnr.:
STSTCD00630063

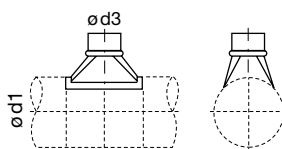

Prijssamenstelling

Excentrische zadelstukken: prijs STSTCD + 50%.

Voorbeeld artikelnr.: STSTD01000100

| ø d1 (mm) | ø d3 | | | | | | | | | | | | | |
|--------------|-------|-------|-------|-------|-------|-------|-------|-------|-------|-------|-------|-------|-------|-------|
| | 63 | 80 | 100 | 125 | 140 | 150 | 160 | 180 | 200 | 224 | 250 | 280 | 300 | 315 |
| 63 | 17,98 | 18,40 | 18,60 | | | | | | | | | | | |
| 80 | 17,98 | 18,40 | 18,60 | 21,26 | 25,12 | 26,33 | | | | | | | | |
| 100 | 18,60 | 18,40 | 18,60 | 21,26 | 25,12 | 26,33 | 27,04 | 28,67 | 30,98 | 36,28 | | | | |
| 125 | 18,60 | 18,40 | 18,60 | 21,26 | 25,12 | 26,33 | 27,04 | 28,67 | 30,98 | 36,28 | | | | |
| 140 | 18,60 | 18,40 | 18,60 | 21,26 | 25,12 | 26,33 | 27,04 | 28,67 | 30,98 | 36,28 | 37,02 | 38,43 | 40,82 | |
| 150 | 18,60 | 18,40 | 18,60 | 21,26 | 25,12 | 26,33 | 27,04 | 28,67 | 30,98 | 36,28 | 37,02 | 38,43 | 40,82 | |
| 160 | 18,60 | 18,40 | 18,60 | 21,26 | 25,12 | 26,33 | 27,04 | 28,67 | 30,98 | 36,28 | 37,02 | 38,43 | 40,82 | |
| 180 | 18,60 | 18,40 | 18,60 | 21,26 | 25,12 | 26,33 | 27,04 | 28,67 | 30,98 | 36,28 | 36,08 | 38,43 | 40,82 | |
| 200 | 18,60 | 18,40 | 18,60 | 21,26 | 25,12 | 26,33 | 27,04 | 28,67 | 30,98 | 36,28 | 37,02 | 38,43 | 40,82 | 43,23 |
| 224 | 18,60 | 18,40 | 18,60 | 21,26 | 25,12 | 26,33 | 27,04 | 28,67 | 30,98 | 36,28 | 37,02 | 38,43 | 40,82 | 43,23 |
| 250 | 18,60 | 19,38 | 19,16 | 21,26 | 25,12 | 26,33 | 27,04 | 30,98 | 32,24 | 36,28 | 37,02 | 38,43 | 40,82 | 43,23 |
| 280 | 19,16 | 19,86 | 22,24 | 23,48 | 25,12 | 26,33 | 22,05 | 32,24 | 32,24 | 36,28 | 38,62 | 41,31 | 40,82 | 43,23 |
| 300 | 19,16 | 19,86 | 22,24 | 23,48 | 25,12 | 36,28 | 27,04 | 32,24 | 32,24 | 36,28 | 38,68 | 41,31 | 40,82 | 43,23 |
| 315 | 19,16 | 19,86 | 22,24 | 23,48 | 25,12 | 26,33 | 27,04 | 32,24 | 32,24 | 37,02 | 38,68 | 41,31 | 40,82 | 43,23 |
| 355 | 19,16 | 20,31 | 22,24 | 23,48 | 36,28 | 27,45 | 28,67 | 32,24 | 33,63 | 37,02 | 40,11 | 41,31 | 40,82 | 43,23 |
| 400 | 19,86 | 22,66 | 22,24 | 23,48 | 26,33 | 27,45 | 28,67 | 32,24 | 33,63 | 37,02 | 40,11 | 41,31 | 40,82 | 43,23 |
| 450 | 21,80 | 22,66 | 23,13 | 23,87 | 27,45 | 28,67 | 29,89 | 34,66 | 34,66 | 39,40 | 41,77 | 43,94 | 45,09 | 45,65 |
| 500 | 21,80 | 22,66 | 23,13 | 23,87 | 27,45 | 28,67 | 29,89 | 34,66 | 34,66 | 39,40 | 41,77 | 43,94 | 45,09 | 45,65 |
| 560 | 22,49 | 23,48 | 23,13 | 25,32 | 29,89 | 30,98 | 32,24 | 34,66 | 36,28 | 42,47 | 45,09 | 47,90 | 48,83 | 49,77 |
| 600 | 22,49 | 23,48 | 23,13 | 25,32 | 29,89 | 30,98 | 32,24 | 34,66 | 36,28 | 42,47 | 45,09 | 47,90 | 48,83 | 49,77 |
| 630 | 22,49 | 23,48 | 23,13 | 25,32 | 29,89 | 30,98 | 34,66 | 35,81 | 36,28 | 42,47 | 47,44 | 47,90 | 48,83 | 48,98 |
| 710 | | | | | | 35,81 | 37,68 | 40,56 | 42,24 | 44,08 | 50,20 | 54,02 | 54,93 | 57,29 |
| 800 | | | | | | | 37,68 | 40,56 | 42,24 | 44,08 | 50,20 | 54,02 | 54,93 | 57,29 |
| 900 | | | | | | | | | 52,61 | 52,61 | 57,29 | 58,71 | 58,71 | 58,71 |
| 1000 | | | | | | | | | 52,61 | 52,61 | 57,29 | 58,71 | 58,71 | 92,04 |
| 1120 | | | | | | | | | | | | | 92,04 | 92,04 |
| 1250 | | | | | | | | | | | | | 92,04 | 92,04 |

| ø d1 (mm) | ø d3 | | | | | | | | | | | | | |
|--------------|-------|-------|-------|-------|--------|--------|--------|--------|--------|--------|--------|--------|--------|--|
| | 355 | 400 | 450 | 500 | 560 | 600 | 630 | 710 | 800 | 900 | 1000 | 1120 | 1250 | |
| 200 | 52,10 | 55,89 | | | | | | | | | | | | |
| 224 | 52,10 | 55,89 | | | | | | | | | | | | |
| 250 | 52,10 | 55,89 | 68,57 | 69,04 | | | | | | | | | | |
| 280 | 52,10 | 55,89 | 68,57 | 72,26 | | | | | | | | | | |
| 300 | 52,10 | 55,89 | 68,57 | 72,26 | 93,62 | 99,86 | | | | | | | | |
| 315 | 52,10 | 55,89 | 68,57 | 72,26 | 93,62 | 99,86 | | | | | | | | |
| 355 | 52,10 | 55,89 | 68,57 | 72,26 | 93,62 | 102,19 | | | | | | | | |
| 400 | 52,10 | 55,89 | 68,57 | 72,26 | 93,62 | 102,19 | 103,76 | | | | | | | |
| 450 | 52,10 | 56,82 | 68,57 | 74,61 | 95,97 | 102,19 | 103,76 | 139,65 | | | | | | |
| 500 | 52,10 | 56,82 | 68,57 | 74,61 | 95,97 | 102,19 | 103,76 | 139,65 | 151,34 | | | | | |
| 560 | 56,82 | 81,52 | 71,35 | 74,61 | 95,97 | 102,19 | 103,76 | 139,65 | 151,34 | 161,47 | | | | |
| 600 | 56,82 | 65,72 | 71,35 | 74,61 | 95,97 | 102,19 | 103,76 | 139,65 | 151,34 | 166,94 | | | | |
| 630 | 58,71 | 65,72 | 77,46 | 76,06 | 95,97 | 102,19 | 103,76 | 139,65 | 151,34 | 166,94 | 189,56 | | | |
| 710 | 68,08 | 76,96 | 85,81 | 86,60 | 95,97 | 104,53 | 106,89 | 144,31 | 151,34 | 212,18 | 231,70 | 368,22 | | |
| 800 | 68,08 | 76,96 | 85,81 | 86,60 | 95,97 | 104,53 | 106,89 | 144,31 | 151,34 | 212,18 | 231,70 | 401,74 | 432,17 | |
| 900 | 75,55 | 82,69 | 86,60 | 88,15 | 110,01 | 110,01 | 110,01 | 152,90 | 156,81 | 219,21 | 231,70 | 413,45 | 432,17 | |
| 1000 | 93,62 | 93,62 | 93,62 | 93,62 | 126,38 | 126,38 | 129,49 | 160,71 | 158,36 | 228,57 | 231,70 | 413,45 | 432,17 | |
| 1120 | 93,62 | 93,62 | 93,62 | 93,62 | 126,38 | 126,38 | 129,49 | 160,71 | 158,36 | 228,57 | 237,93 | 413,45 | 432,17 | |
| 1250 | 85,53 | 85,53 | 85,53 | 85,53 | 115,46 | 115,46 | 118,30 | 146,82 | 144,67 | 208,82 | 217,37 | 377,72 | 394,82 | |

R-VENT® Sendzimir verzinkte geperste T-stukken 90°

Artikelgroep 10

T-stuk STCPD

Voorbeeld artikelnr.:
STCPD063063

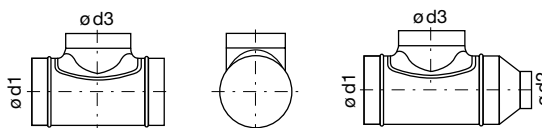

Prijssamenstelling
Verlopende T-stukken:
prijs STCPD + prijs SRCLD + 30%.
Voorbeeld artikelnr.:
STCPR100808

| $\varnothing d1$ (mm) | $\varnothing d3$ | | | | | | | | | | | | | |
|--------------------------|------------------|-------|-------|-------|-------|-------|-------|-------|-------|-------|-------|-------|--------|-------|
| | 63 | 80 | 100 | 125 | 140 | 150 | 160 | 180 | 200 | 224 | 250 | 300 | 315 | 400 |
| 63 | 15,80 | | | | | | | | | | | | | |
| 80 | 13,89 | 13,89 | | | | | | | | | | | | |
| 100 | 11,69 | 11,62 | 10,27 | | | | | | | | | | | |
| 125 | 13,89 | 13,89 | 11,40 | 11,40 | | | | | | | | | | |
| 140 | | 14,89 | 14,89 | 17,59 | 17,89 | | | | | | | | | |
| 150 | | 15,48 | 15,48 | 17,83 | 18,37 | 17,83 | | | | | | | | |
| 160 | | 15,52 | 15,22 | 17,05 | 18,67 | 18,12 | 18,12 | | | | | | | |
| 180 | | 17,17 | 16,82 | 19,59 | 21,05 | 21,77 | 23,69 | 24,69 | | | | | | |
| 200 | | 17,52 | 16,49 | 18,18 | 23,09 | 21,77 | 22,73 | 27,27 | 26,06 | | | | | |
| 224 | | 21,02 | 18,84 | 20,69 | 24,69 | 24,69 | 25,24 | 28,74 | 29,11 | 33,99 | | | | |
| 250 | | 19,42 | 19,42 | 19,42 | 23,13 | 22,80 | 23,09 | 31,48 | 28,74 | 33,99 | 33,99 | | | |
| 280 | | 23,48 | 23,48 | 23,48 | 25,58 | 25,58 | 25,58 | 30,86 | 30,86 | 35,29 | 35,29 | | | |
| 300 | | 23,48 | 23,48 | 23,48 | 25,58 | 25,58 | 25,58 | 30,86 | 30,86 | 35,29 | 35,29 | 44,70 | | |
| 315 | | 23,48 | 23,48 | 23,48 | 25,58 | 25,58 | 25,58 | 30,86 | 30,86 | 35,29 | 35,29 | 44,70 | 42,94 | |
| 355 | | | 36,32 | 36,32 | 36,47 | 36,47 | 38,22 | 38,38 | 38,38 | 42,47 | 41,31 | 44,70 | 44,70 | |
| 400 | | | 36,32 | 36,32 | | | 36,47 | | 40,14 | 46,69 | 44,53 | | 44,96 | 60,11 |
| 450 | | | 46,22 | 46,22 | | | 46,22 | | 50,20 | | 53,05 | | 60,11 | |
| 500 | | | 44,50 | 44,50 | | | 45,87 | | 54,93 | | 61,52 | | 71,86 | |
| 560 | | | 60,11 | 60,11 | | | 60,11 | | 71,35 | | 73,64 | | 79,58 | |
| 600 | | | 64,74 | 64,74 | | | 64,74 | | 88,93 | | 92,84 | | 95,18 | |
| 630 | | | 64,74 | 64,74 | | | 64,74 | | 95,97 | | 98,29 | | 100,63 | |

Kruisstuk SXCPD

Voorbeeld artikelnr.:
SXCPD063063

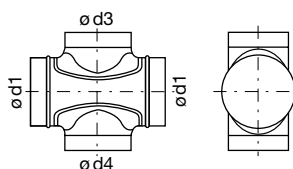

| $\varnothing d1$ (mm) | $\varnothing d3 - \varnothing d4$ | | | | | | | | | | | | | |
|--------------------------|-----------------------------------|-------|--------|--------|-------|-------|--------|--------|--------|--------|--------|-----|--------|-----|
| | 63 | 80 | 100 | 125 | 140 | 150 | 160 | 180 | 200 | 224 | 250 | 300 | 315 | 400 |
| 63 | 35,11 | | | | | | | | | | | | | |
| 80 | 29,80 | 32,80 | | | | | | | | | | | | |
| 100 | 31,94 | 31,94 | 36,32 | | | | | | | | | | | |
| 125 | 34,17 | 34,42 | 37,65 | 40,37 | | | | | | | | | | |
| 140 | | 40,37 | 40,63 | 45,65 | 53,05 | | | | | | | | | |
| 150 | | 40,37 | 40,63 | 45,65 | 53,05 | 53,05 | | | | | | | | |
| 160 | | 40,37 | 40,63 | 45,65 | 53,05 | 53,05 | 53,05 | | | | | | | |
| 180 | | 45,65 | 47,44 | 53,05 | 60,11 | 60,11 | 60,54 | 67,13 | | | | | | |
| 200 | | 45,65 | 47,44 | 53,05 | 60,11 | 60,11 | 60,11 | 67,13 | 67,13 | | | | | |
| 224 | | 53,05 | 58,22 | 59,60 | 67,13 | 67,13 | 67,13 | 77,46 | 77,46 | 86,60 | | | | |
| 250 | | 53,05 | 58,22 | 59,60 | 67,13 | 67,13 | 67,13 | 77,46 | 77,46 | 86,60 | 86,60 | | | |
| 280 | | 61,94 | 67,13 | 70,88 | 78,79 | 78,79 | 78,79 | 92,84 | 92,84 | 99,07 | 99,07 | | | |
| 300 | | 61,94 | 67,13 | 70,88 | 78,79 | 78,79 | 78,79 | 92,84 | 92,84 | 99,07 | 99,07 | | | |
| 315 | | 61,94 | 67,13 | 70,88 | 78,79 | 78,79 | 78,79 | 92,84 | 92,84 | 99,07 | 99,07 | | 111,55 | |
| 355 | | | 85,03 | 86,60 | 98,29 | 98,29 | 98,29 | 107,66 | 107,66 | 117,79 | 117,79 | | 127,94 | |
| 400 | | | 99,07 | 107,66 | | | 116,25 | | 125,59 | 133,41 | 133,41 | | 144,31 | |
| 450 | | | 140,41 | 144,31 | | | 148,22 | | 152,90 | 161,47 | 161,47 | | 173,98 | |
| 500 | | | 140,41 | 144,31 | | | 148,22 | | 152,90 | | 161,47 | | 173,98 | |
| 560 | | | | 204,38 | | | 215,32 | | 223,90 | | 232,49 | | 242,61 | |
| 600 | | | | 204,38 | | | 215,32 | | 223,90 | | 232,49 | | 242,61 | |
| 630 | | | | 204,38 | | | 215,32 | | 223,90 | | 232,49 | | 242,61 | |

R-VENT® Sendzimir verzinkte centrische T-stukken 45°

Artikelgroep 10

T-stuk 45° ST2D

Voorbeeld artikelnr.:
ST2D00630063

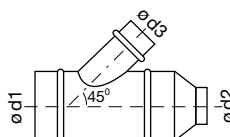
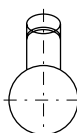
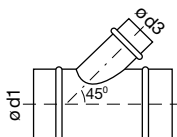

Prijsamenstelling
Verlopende T-stukken 45°:
prijs ST2D + prijs SRCLD + 30%.
Voorbeeld artikelnr.:
ST2R012010010

| ø d1 (mm) | ø d3 | | | | | | | | | | | | | |
|--------------|-------|-------|-------|-------|-------|-------|--------|--------|--------|--------|--------|--------|--------|--------|
| | 63 | 80 | 100 | 125 | 140 | 150 | 160 | 180 | 200 | 224 | 250 | 280 | 300 | 315 |
| 63 | 15,87 | | | | | | | | | | | | | |
| 80 | 15,48 | 15,48 | | | | | | | | | | | | |
| 100 | 16,79 | 8,70 | 9,12 | | | | | | | | | | | |
| 125 | 17,96 | 9,23 | 9,12 | 10,15 | | | | | | | | | | |
| 140 | 20,31 | 19,84 | 24,35 | 25,21 | 26,73 | | | | | | | | | |
| 150 | 20,63 | 24,42 | 20,31 | 20,31 | 27,26 | 19,81 | | | | | | | | |
| 160 | 19,17 | 19,35 | 10,01 | 10,51 | 30,67 | 33,55 | 13,10 | | | | | | | |
| 180 | 20,52 | 28,79 | 30,32 | 20,16 | 34,65 | 37,13 | 41,29 | 46,22 | | | | | | |
| 200 | 19,63 | 19,63 | 11,04 | 11,64 | 37,88 | 20,95 | 13,70 | 23,04 | 17,29 | | | | | |
| 224 | 21,41 | 37,88 | 37,88 | 38,84 | 39,94 | 42,00 | 45,62 | 48,64 | 22,26 | 51,51 | | | | |
| 250 | 24,35 | 39,09 | 23,68 | 23,71 | 41,11 | 24,32 | 15,27 | 50,16 | 18,74 | 53,89 | 25,24 | | | |
| 280 | 27,90 | 42,32 | 42,32 | 42,32 | 44,20 | 46,51 | 51,16 | 47,46 | 54,56 | 57,55 | 61,24 | 27,19 | | |
| 300 | 28,90 | 47,68 | 47,68 | 47,68 | 49,56 | 51,51 | 52,97 | 56,02 | 58,93 | 60,81 | 64,11 | 67,70 | 28,15 | |
| 315 | 29,50 | 52,86 | 52,86 | 27,34 | 52,86 | 54,00 | 27,34 | 56,87 | 30,81 | 30,81 | 30,81 | 29,50 | 76,22 | 28,83 |
| 355 | | 55,77 | 55,77 | 55,77 | 55,77 | 55,77 | 57,97 | 31,99 | 62,44 | 64,72 | 31,45 | 73,31 | 81,40 | 85,59 |
| 400 | | 62,94 | 62,94 | 62,94 | 86,60 | 62,94 | 62,94 | 64,97 | 31,45 | 69,15 | 32,23 | 76,22 | 33,87 | 33,02 |
| 450 | | | 73,66 | 73,66 | 73,66 | 73,66 | 73,66 | 73,66 | 39,87 | 79,38 | 40,79 | 88,04 | 94,68 | 104,05 |
| 500 | | | 87,19 | 87,19 | 87,19 | 87,19 | 40,54 | 40,61 | 87,19 | 91,38 | 35,57 | 96,74 | 106,36 | 58,36 |
| 560 | | | | | | | 98,19 | 98,19 | 98,19 | 98,19 | 101,25 | 104,23 | 114,17 | 120,98 |
| 600 | | | | | | | 108,06 | 108,06 | 108,06 | 108,06 | 108,06 | 114,17 | 123,36 | 127,37 |
| 630 | | | | | | | 137,17 | 137,17 | 137,17 | 137,17 | 137,17 | 137,17 | 142,39 | 146,97 |

| ø d1 (mm) | ø d3 | | | | | | |
|--------------|--------|--------|--------|--------|--------|--------|--------|
| | 355 | 400 | 450 | 500 | 560 | 600 | 630 |
| 355 | 31,20 | | | | | | |
| 400 | 96,92 | 58,36 | | | | | |
| 450 | 111,29 | 111,36 | 129,18 | | | | |
| 500 | 120,24 | 65,28 | 135,65 | 81,37 | | | |
| 560 | 127,05 | 133,76 | 142,96 | 153,72 | 167,24 | | |
| 600 | 133,27 | 141,01 | 151,34 | 161,95 | 171,57 | 181,01 | |
| 630 | 158,37 | 175,16 | 189,22 | 205,40 | 224,94 | 234,94 | 291,38 |

Vet cursief gedrukte diameters zijn aanbevolen en toegevoegde NEN-EN 1506 diameters en veelal voorradig.

Prijzen voor verzinkte kruisstukken SX2D - 45° zijn op aanvraag verkrijgbaar.

Broekstuk 45° SYD

Voorbeeld artikelnr.:
SYD0080008045

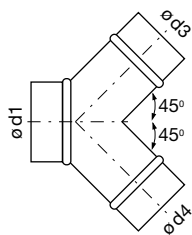

Broekstuk 22,5° SYD

Voorbeeld artikelnr.:
SYD0080008022

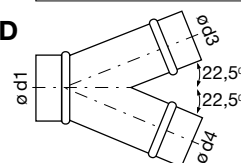

| $\varnothing d1$ (mm) | $\varnothing d3/d4$ (mm) | 45° | 22,5° |
|--------------------------|-----------------------------|---------------|---------------|
| 80 | 80 | 11,93 | 22,44 |
| 100 | 100 | 17,79 | 24,71 |
| 125 | 125 | 19,05 | 34,04 |
| 150 | 150 | 22,51 | 34,83 |
| 160 | 160 | 27,32 | 35,29 |
| 180 | 180 | 38,66 | 38,34 |
| 200 | 200 | 32,84 | 43,52 |
| 224 | 224 | 54,28 | 53,92 |
| 250 | 250 | 65,32 | 73,52 |
| 280 | 280 | 76,36 | 75,01 |
| 300 | 300 | 106,78 | 104,48 |
| 315 | 315 | 87,00 | 114,10 |
| 355 | 355 | 97,63 | 126,70 |
| 400 | 400 | 99,61 | 142,00 |
| 450 | 450 | 134,37 | 163,30 |
| 500 | 500 | 235,15 | 248,50 |
| 560 | 560 | 252,05 | 284,00 |
| 600 | 600 | 312,40 | 337,25 |
| 630 | 630 | 312,40 | 337,25 |

Vet cursief gedrukte diameters zijn aanbevolen en toegevoegde NEN-EN 1506 diameters en veelal voorradig.

Zadelstuk SPSD

Voorbeeld artikelnr.:
SPSD080080

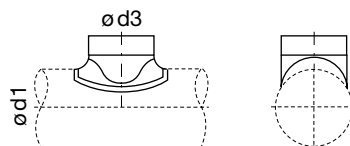

| $\phi d1$ (mm) | $\phi d3$ | | | | | | | | | | | | | |
|-------------------|-----------|------|------|------|------|------|------|------|------|-------|-------|-------|-------|-------|
| | 63 | 80 | 100 | 125 | 140 | 150 | 160 | 180 | 200 | 224 | 250 | 300 | 315 | 400 |
| 63 | 4,54 | | | | | | | | | | | | | |
| 80 | 4,54 | 4,54 | | | | | | | | | | | | |
| 100 | 4,54 | 4,54 | 4,29 | | | | | | | | | | | |
| 125 | | 4,54 | 4,29 | 5,23 | | | | | | | | | | |
| 140 | | | | | 7,76 | | | | | | | | | |
| 150 | | | | | | 7,24 | | | | | | | | |
| 160 | | 4,54 | 4,29 | 5,23 | 7,76 | 7,24 | 7,10 | | | | | | | |
| 180 | | | | | | | | 9,01 | | | | | | |
| 200 | | 4,54 | 4,29 | 5,23 | 7,76 | 7,24 | 7,10 | 9,01 | 9,21 | | | | | |
| 224 | | | | | | | | | | 13,89 | | | | |
| 250 | | 4,54 | 4,29 | 5,23 | 7,76 | 7,24 | 7,10 | 9,01 | 9,21 | 13,89 | 12,79 | | | |
| 280 | | | | | | | | | | | | | | |
| 300 | | | | | | | | | | | | 17,48 | | |
| 315 | | | 4,29 | 5,23 | 7,76 | 7,24 | 7,10 | 9,01 | 9,21 | 13,89 | 12,79 | 17,48 | 17,13 | |
| 355 | | | | | | | | | | | | | | |
| 400 | | | | | 7,76 | | 7,10 | 9,01 | 9,21 | | 12,79 | 17,48 | 17,13 | 31,01 |
| 450 | | | | | | | | | | | | | | |
| 500 | | | 4,29 | 5,23 | | 7,24 | 7,10 | 9,01 | 9,21 | 13,89 | 12,79 | 17,48 | 17,13 | 31,01 |
| 560 | | | | | | | | | | | | | | |
| 600 | | | | | | | | | | | | | | |
| 630 | | | | | | | 7,10 | | 9,21 | | 12,79 | | 17,13 | 31,01 |

Vet cursief gedrukte diameters zijn aanbevolen en toegevoegde NEN-EN 1506 diameters en veelal voorradig.
De geperste zadelstukken zijn veelal geschikt voor montage op meerdere buisdiameters. Zie onderstaand overzicht

| Artikelnummer | Aftakking ϕd^3 | buis diameters | Artikelnummer | Aftakking ϕd^3 | buis diameters |
|---------------|----------------------|--------------------|---------------|----------------------|--------------------|
| SPSD063063 | 63 | buis 63mm | SPSD250250 | 250 | buis 250mm |
| SPSD080063 | 63 | buis 80mm | SPSD300300 | 300 | buis 300mm |
| SPSD080080 | 80 | buis 80mm | SPSD315100 | 100 | buis 280 t/m 355mm |
| SPSD100063 | 63 | buis 100mm | SPSD315125 | 125 | buis 280 t/m 355mm |
| SPSD100080 | 80 | buis 100mm | SPSD315140 | 140 | buis 280 t/m 355mm |
| SPSD100100 | 100 | buis 100mm | SPSD315150 | 150 | buis 280 t/m 355mm |
| SPSD125063 | 63 | buis 112-125mm | SPSD315160 | 160 | buis 280 t/m 315mm |
| SPSD125080 | 80 | buis 112 t/m 140mm | SPSD315180 | 180 | buis 280 t/m 355mm |
| SPSD125100 | 100 | buis 112 t/m 140mm | SPSD315200 | 200 | buis 250 t/m 315mm |
| SPSD125125 | 125 | buis 125mm | SPSD315224 | 224 | buis 280 t/m 355mm |
| SPSD140140 | 140 | buis 140mm | SPSD315250 | 250 | buis 300-315mm |
| SPSD150150 | 150 | buis 150mm | SPSD315300 | 300 | buis 315mm |
| SPSD160063 | 63 | buis 112 t/m 160mm | SPSD315315 | 315 | buis 315mm |
| SPSD160080 | 80 | buis 150-160mm | SPSD400140 | 140 | buis 355 t/m 500mm |
| SPSD160100 | 100 | buis 150-160mm | SPSD400160 | 160 | buis 355-400mm |
| SPSD160125 | 125 | buis 140 t/m 160mm | SPSD400180 | 180 | buis 355 t/m 450mm |
| SPSD160140 | 140 | buis 150-160mm | SPSD400200 | 200 | buis 355-400mm |
| SPSD160150 | 150 | buis 160mm | SPSD400250 | 250 | buis 355-400mm |
| SPSD160160 | 160 | buis 160mm | SPSD400300 | 300 | buis 355-400mm |
| SPSD180180 | 180 | buis 180mm | SPSD400315 | 315 | buis 400mm |
| SPSD200080 | 80 | buis 180-200mm | SPSD400400 | 400 | buis 400mm |
| SPSD200100 | 100 | buis 180-200mm | SPSD500100 | 100 | buis 400 t/m 630mm |
| SPSD200125 | 125 | buis 180-200mm | SPSD500125 | 125 | buis 400 t/m 630mm |
| SPSD200140 | 140 | buis 180-200mm | SPSD500150 | 150 | buis 400-500mm |
| SPSD200150 | 150 | buis 180-200mm | SPSD500160 | 160 | buis 450 t/m 560mm |
| SPSD200160 | 160 | buis 180-200mm | SPSD500180 | 180 | buis 500 t/m 630mm |
| SPSD200180 | 180 | buis 200mm | SPSD500200 | 200 | buis 450 t/m 560mm |
| SPSD200200 | 200 | buis 200mm | SPSD500224 | 224 | buis 400 t/m 630mm |
| SPSD224224 | 224 | buis 224mm | SPSD500250 | 250 | buis 450 t/m 560mm |
| SPSD250080 | 80 | buis 224 t/m 315mm | SPSD500300 | 300 | buis 450 t/m 630mm |
| SPSD250100 | 100 | buis 224-250mm | SPSD500315 | 315 | buis 450 t/m 560mm |
| SPSD250125 | 125 | buis 224-250mm | SPSD500400 | 400 | buis 450 t/m 560mm |
| SPSD250140 | 140 | buis 224-250mm | SPSD630160 | 160 | buis 600-630mm |
| SPSD250150 | 150 | buis 224-250mm | SPSD630200 | 200 | buis 600-630mm |
| SPSD250160 | 160 | buis 224-250mm | SPSD630250 | 250 | buis 600-630mm |
| SPSD250180 | 180 | buis 224-250mm | SPSD630315 | 315 | buis 600-630mm |
| SPSD250200 | 200 | buis 224-250mm | SPSD630400 | 400 | buis 600-630mm |
| SPSD250224 | 224 | buis 250mm | | | |

Zadelstuk 45° SPS2D

Voorbeeld artikelnr.:
SPS2D00800080

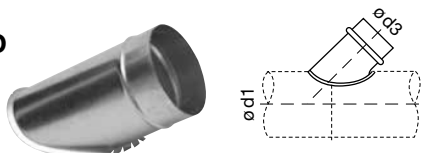

| ø d1 (mm) | ø d3 | | | | | | | | | | | | | | |
|--------------|-------|-------|-------|-------|-------|-------|-------|-------|-------|-------|-------|-------|-------|-------|--|
| | 63 | 80 | 100 | 125 | 140 | 150 | 160 | 180 | 200 | 224 | 250 | 280 | 300 | 315 | |
| 80 | 11,54 | 4,44 | | | | | | | | | | | | | |
| 100 | 11,54 | 3,69 | 5,25 | | | | | | | | | | | | |
| 125 | 3,73 | 4,05 | 4,62 | 5,75 | | | | | | | | | | | |
| 140 | 5,64 | 5,64 | 5,64 | 5,64 | 8,98 | | | | | | | | | | |
| 150 | 5,64 | 5,64 | 5,64 | 5,64 | 8,98 | 8,98 | | | | | | | | | |
| 160 | 3,76 | 3,66 | 4,47 | 5,08 | 9,62 | 9,62 | 6,57 | | | | | | | | |
| 180 | 7,99 | 7,99 | 7,99 | 7,99 | 7,31 | 7,31 | 8,02 | 11,22 | | | | | | | |
| 200 | 3,76 | 3,76 | 4,47 | 5,08 | 7,31 | 7,31 | 6,25 | 11,22 | 9,02 | | | | | | |
| 224 | 3,80 | 3,80 | 3,80 | 5,11 | 7,49 | 7,49 | 7,81 | 9,19 | 11,08 | 14,66 | | | | | |
| 250 | 3,80 | 3,80 | 4,30 | 4,97 | 7,49 | 7,49 | 6,21 | 9,19 | 7,95 | 14,66 | 12,50 | | | | |
| 280 | 9,87 | 9,87 | 9,87 | 9,87 | 9,87 | 9,87 | 9,87 | 9,87 | 12,89 | 14,73 | 14,73 | 15,58 | | | |
| 300 | 9,48 | 9,48 | 9,48 | 9,48 | 9,48 | 9,48 | 9,48 | 12,89 | 12,89 | 14,73 | 14,73 | 15,58 | 15,58 | | |
| 315 | 11,54 | 11,54 | 4,19 | 4,97 | 15,58 | 10,51 | 6,11 | 15,58 | 7,77 | 14,73 | 10,54 | 15,58 | 15,58 | 16,90 | |
| 355 | 7,49 | 7,49 | 7,49 | 7,49 | 8,38 | 8,38 | 8,38 | 10,65 | 10,65 | 10,65 | 13,06 | 12,50 | 12,50 | 19,49 | |
| 400 | 6,67 | 6,67 | 6,67 | 8,31 | 10,26 | 10,26 | 10,26 | 12,71 | 12,71 | 20,95 | 20,95 | 19,42 | 19,42 | 26,31 | |
| 450 | 11,54 | 12,85 | 14,09 | 15,12 | 16,15 | 16,15 | 16,15 | 16,76 | 16,76 | 16,76 | 16,76 | 25,42 | 25,42 | 25,42 | |
| 500 | 11,32 | 11,32 | 11,32 | 11,32 | 11,32 | 11,32 | 12,07 | 11,32 | 11,32 | 14,87 | 14,87 | 36,71 | 36,71 | 25,60 | |
| 560 | 11,72 | 11,72 | 18,64 | 12,03 | 22,58 | 22,58 | 22,58 | 55,84 | 58,54 | 32,70 | 35,75 | 38,84 | 42,74 | 45,23 | |
| 600 | 36,17 | 18,64 | 18,64 | 22,58 | 22,58 | 22,58 | 22,58 | 27,26 | 27,26 | 32,70 | 30,71 | 38,84 | 42,74 | 45,23 | |
| 630 | 36,17 | 18,64 | 21,12 | 22,58 | 22,58 | 22,58 | 22,58 | 27,26 | 26,87 | 32,70 | 30,71 | 38,84 | 42,74 | 30,71 | |

| ø d1 (mm) | ø d3 | |
|--------------|-------|-------|
| | 355 | 400 |
| 355 | 30,74 | |
| 400 | 30,49 | 30,10 |
| 450 | 30,74 | 30,10 |
| 500 | 30,49 | 30,10 |
| 560 | 65,82 | 78,70 |
| 600 | 65,82 | 78,70 |
| 630 | 64,79 | 36,49 |

Verloopstuk SRCLD

Voorbeeld artikelnr.:
SRCLD00800063

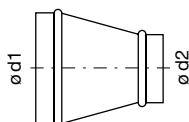

Prijssamenstelling
Excentrische verloopstuk SRLD:
 prijs SRLD = prijs SRCLD + 50%.
 Voorbeeld artikelnr.: SRLD00800063

| ø d1 (mm) | ø d3 | | | | | | | | | | | | | |
|--------------|-------|-------|-------|-------|-------|-------|--------|-------|--------|-------|--------|--------|--------|--------|
| | 63 | 80 | 100 | 125 | 140 | 150 | 160 | 180 | 200 | 224 | 250 | 280 | 300 | 315 |
| 80 | 12,48 | | | | | | | | | | | | | |
| 100 | 13,45 | 13,45 | | | | | | | | | | | | |
| 125 | 14,11 | 14,11 | 14,11 | | | | | | | | | | | |
| 140 | 16,73 | 15,99 | 15,38 | 14,67 | | | | | | | | | | |
| 150 | 16,73 | 15,99 | 15,38 | 14,67 | 14,67 | | | | | | | | | |
| 160 | 17,20 | 16,73 | 15,99 | 15,38 | 15,38 | 15,38 | | | | | | | | |
| 180 | 17,71 | 16,97 | 16,97 | 16,73 | 16,73 | 16,49 | 16,49 | | | | | | | |
| 200 | 16,82 | 17,71 | 17,71 | 17,20 | 17,20 | 17,20 | 16,73 | 16,73 | | | | | | |
| 224 | 21,53 | 20,54 | 20,54 | 20,31 | 20,31 | 20,31 | 19,16 | 19,16 | 18,87 | | | | | |
| 250 | 23,13 | 22,94 | 22,94 | 22,49 | 22,49 | 22,49 | 21,80 | 21,80 | 21,26 | 21,26 | | | | |
| 280 | 24,38 | 24,11 | 24,11 | 23,69 | 23,69 | 23,69 | 23,13 | 23,13 | 22,94 | 22,94 | 21,88 | | | |
| 300 | 27,45 | 26,78 | 26,03 | 25,09 | 25,09 | 25,09 | 24,81 | 24,81 | 24,38 | 24,38 | 19,65 | 20,22 | | |
| 315 | 27,45 | 26,78 | 26,03 | 25,09 | 25,78 | 25,09 | 24,81 | 24,81 | 24,38 | 24,38 | 21,92 | 21,29 | 20,79 | |
| 355 | 30,86 | 30,08 | 29,11 | 28,90 | 28,90 | 28,90 | 28,20 | 28,20 | 29,91 | 27,74 | 25,32 | 24,38 | 23,69 | 22,60 |
| 400 | 41,77 | 40,82 | 40,33 | 39,63 | 39,63 | 39,63 | 38,43 | 38,43 | 38,43 | 38,43 | 30,67 | 31,64 | 28,94 | 27,85 |
| 450 | | | 45,87 | 45,65 | 45,65 | 45,65 | 43,42 | 43,42 | 42,47 | 42,47 | 39,01 | 39,01 | 37,07 | 36,04 |
| 500 | | | 53,05 | 53,05 | 53,05 | 53,05 | 51,66 | 51,66 | 51,66 | 49,33 | 45,16 | 44,79 | 44,63 | 40,59 |
| 560 | | | | 64,74 | | | 62,43 | | 61,52 | | 60,54 | 59,60 | 56,82 | 56,33 |
| 600 | | | | | | | 80,36 | | 78,79 | | 70,41 | 69,94 | 68,49 | 63,86 |
| 630 | | | | | | | 80,36 | | 81,91 | | 71,35 | 74,14 | 63,86 | 63,86 |
| 710 | | | | | | | 123,26 | | 120,14 | | 113,12 | 113,12 | 113,12 | 74,90 |
| 800 | | | | | | | | | 149,76 | | 145,88 | 145,88 | 145,88 | 141,98 |

| ø d1 (mm) | ø d3 | | | | | | | | | | | | | |
|--------------|--------|--------|--------|--------|--------|--------|--------|--------|--------|--------|--------|--------|--|--|
| | 355 | 400 | 450 | 500 | 560 | 600 | 630 | 710 | 800 | 900 | 1000 | 1120 | | |
| 400 | 27,82 | | | | | | | | | | | | | |
| 450 | 35,47 | 34,42 | | | | | | | | | | | | |
| 500 | 40,14 | 37,07 | 37,56 | | | | | | | | | | | |
| 560 | 52,61 | 51,66 | 49,77 | 47,90 | | | | | | | | | | |
| 600 | 62,92 | 62,43 | 61,94 | 60,54 | 59,60 | | | | | | | | | |
| 630 | 63,39 | 61,94 | 57,29 | 55,37 | 54,93 | 61,94 | | | | | | | | |
| 710 | 99,86 | 92,04 | 92,04 | 86,60 | 86,60 | 90,50 | 79,58 | | | | | | | |
| 800 | 139,65 | 116,25 | 117,79 | 108,43 | 114,67 | 129,49 | 106,10 | 106,10 | | | | | | |
| 900 | | 191,11 | 202,04 | 185,65 | 183,32 | 203,60 | 173,18 | 169,28 | 160,71 | | | | | |
| 1000 | | | | 211,41 | 194,24 | 209,85 | 209,06 | 189,56 | 181,76 | 176,28 | | | | |
| 1120 | | | | | 379,13 | 360,41 | 341,69 | 288,65 | 272,26 | 257,43 | 244,17 | | | |
| 1250 | | | | | 430,62 | 413,45 | 393,96 | 376,02 | 357,29 | 339,34 | 288,65 | 282,40 | | |

Vet cursief gedrukte diameters zijn aanbevolen en toegevoegde NEN-EN 1506 diameters en veelal voorradig.



Verloopstuk SRCD (voor buizen)

Voorbeeld artikelnr.:
SRCD00800063

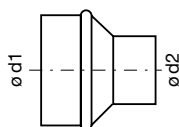

SRCD: $\varnothing d1$ en $\varnothing d2$ passen in de buis.

| $\varnothing d1$ (mm) | $\varnothing d3$ | | | | | | | | | | | | | |
|--------------------------|------------------|------|-------|-------|-------|-------|-------|-------|-------|-------|-------|-------|-------|--|
| | 63 | 80 | 100 | 125 | 150 | 160 | 180 | 200 | 224 | 250 | 315 | 400 | 500 | |
| 80 | 5,42 | | | | | | | | | | | | | |
| 100 | 5,42 | 7,21 | | | | | | | | | | | | |
| 125 | | 6,21 | 6,21 | | | | | | | | | | | |
| 150 | | | 7,28 | 7,28 | | | | | | | | | | |
| 160 | | 6,51 | 6,51 | 6,51 | 7,28 | | | | | | | | | |
| 180 | | | 8,54 | 8,54 | 8,54 | 8,54 | | | | | | | | |
| 200 | | | 11,32 | 9,95 | 9,51 | 8,61 | 9,84 | | | | | | | |
| 224 | | | | | 11,32 | 11,32 | 11,32 | 10,68 | | | | | | |
| 250 | | | | 13,66 | 13,07 | 11,40 | 13,07 | 10,77 | 12,37 | | | | | |
| 300 | | | | | | | | 13,45 | | 14,76 | | | | |
| 315 | | | | | | 14,16 | | 14,16 | | 14,16 | | | | |
| 355 | | | | | | | | | | 24,59 | 23,33 | | | |
| 400 | | | | | | | | 34,66 | | 35,66 | 34,60 | | | |
| 500 | | | | | | | | | | 54,93 | 50,20 | 49,26 | | |
| 630 | | | | | | | | | | | 73,25 | 86,60 | 92,84 | |

Vet cursief gedrukte diameters zijn aanbevolen en toegevoegde NEN-EN 1506 diameters en veelal voorradig.

Verloopstuk SRCF (voor hulpstukken/buizen)

Voorbeeld artikelnr.:
SRCF080063

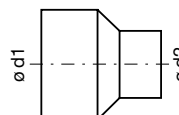

SRCF: $\varnothing d1$ schuift over het hulpstuk,
 $\varnothing d2$ past in de buis.

| $\varnothing d1$ (mm) | $\varnothing d3$ | | | | | | | | | | | | | |
|--------------------------|------------------|------|------|-------|-------|-------|-------|-------|-------|-------|-------|-------|-------|--|
| | 63 | 80 | 100 | 125 | 150 | 160 | 180 | 200 | 224 | 250 | 315 | 400 | 500 | |
| 80 | 5,03 | | | | | | | | | | | | | |
| 100 | 5,03 | 5,03 | | | | | | | | | | | | |
| 125 | | 6,32 | 6,32 | | | | | | | | | | | |
| 150 | | | 7,24 | 7,24 | | | | | | | | | | |
| 160 | | 6,55 | 6,55 | 6,55 | 7,24 | | | | | | | | | |
| 180 | | | 8,54 | 8,54 | 8,54 | 8,54 | | | | | | | | |
| 200 | | | 8,13 | 8,13 | 9,51 | 9,39 | 12,71 | | | | | | | |
| 224 | | | | | 11,32 | 11,32 | 11,32 | 10,68 | | | | | | |
| 250 | | | | 11,32 | 13,07 | 11,78 | 13,07 | 11,82 | 12,37 | | | | | |
| 300 | | | | | | | | 14,70 | | 13,42 | | | | |
| 315 | | | | | | 13,19 | | 13,19 | | 13,19 | | | | |
| 355 | | | | | | | | | | 24,63 | 23,33 | | | |
| 400 | | | | | | | | 34,66 | | 35,66 | 34,60 | | | |
| 500 | | | | | | | | | | 51,18 | 50,70 | 50,70 | | |
| 630 | | | | | | | | | | | 73,25 | 86,60 | 92,84 | |

Vet cursief gedrukte diameters zijn aanbevolen en toegevoegde NEN-EN 1506 diameters en veelal voorradig.



SNPD
Verbindingsstuk voor buizen
Voorbeeld artikelnr.:
SNPD0063



SVENPD
Verbindingsstuk verlengd,
voor buizen
Voorbeeld artikelnr.:
SVENPD0063



SMFD
Verbindingsstuk voor
hulpstukken
Voorbeeld artikelnr.:
SMFD0063



SEPD
Deksel voor buizen
Voorbeeld artikelnr.:
SEPD0063



SEPF
Deksel voor hulpstukken
Voorbeeld artikelnr.:
SEPF0063



SILD
Vlak zadelstuk
Voorbeeld artikelnr.:
SILD0063



SILRD
Vlak stromend zadelstuk
Voorbeeld artikelnr.:
SILRD063



SIL2D
Zadelstuk 450
Voorbeeld artikelnr.:
SIL2D063



SVLG
Verzinkt rozet
Voorbeeld artikelnr.:
SVLG



SFLD
Flens
Voorbeeld artikelnr.:
SFLD0080



SNPK
Buis verbindingsstuk
met één krimp eind
Voorbeeld artikelnr.:
SNPK0125

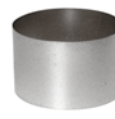

SVB
Verbindingsstuk zonder ril (hulpstukmaat)
Voorbeeld artikelnr.:
SVB0125

| ø d1 (mm) | SNPD | SVENPD | SMFD | SEPD | SEPF | SILD | SILRD | SIL2D | SVLG | SFLD | SNPK | SVB artikelnr | |
|--------------|-------|--------|-------|--------|--------|-------|-------|--------|--------|--------|------|------------------|------|
| 63 | 2,38 | | 2,38 | 1,91 | 2,94 | 3,89 | 4,34 | | | | | | |
| 80 | 1,86 | 3,56 | 1,86 | 2,18 | 3,20 | 2,65 | 3,32 | 14,38 | | 19,38 | | | |
| 100 | 1,91 | 3,67 | 1,91 | 2,18 | 3,20 | 2,65 | 3,56 | 15,52 | 13,65 | 12,71 | | SVB10077 | 1,52 |
| 125 | 1,91 | 3,67 | 1,91 | 2,45 | 3,67 | 3,05 | 3,86 | 16,73 | 16,67 | 12,71 | 2,38 | SVB12577 | 1,53 |
| 140 | 2,38 | 4,57 | 2,38 | 2,84 | 4,29 | 3,59 | 4,34 | 18,84 | | 15,95 | | | |
| 150 | 2,21 | 4,41 | 2,21 | 2,81 | 4,14 | 3,86 | 4,54 | 19,59 | 16,72 | 15,52 | 2,65 | SVB15077 | 1,96 |
| 160 | 2,42 | 4,65 | 2,42 | 2,68 | 4,06 | 3,89 | 4,86 | 20,51 | 16,72 | 16,62 | | | |
| 180 | 2,65 | 5,23 | 2,65 | 4,09 | 6,12 | 4,60 | 5,57 | 21,53 | 18,09 | 17,80 | | SVB18077 | 2,42 |
| 200 | 2,65 | 5,26 | 2,65 | 4,14 | 6,21 | 4,41 | 5,57 | 22,43 | 19,31 | 20,22 | | | |
| 224 | 3,05 | 5,97 | 3,05 | 5,00 | 7,33 | 5,80 | 6,55 | 23,64 | | 22,12 | | | |
| 250 | 3,16 | 6,12 | 3,16 | 5,00 | 7,36 | 5,39 | 8,02 | 25,00 | 22,98 | 22,24 | | | |
| 280 | 4,65 | 9,28 | 4,65 | 7,21 | 10,71 | 8,47 | | 27,93 | | 29,72 | | | |
| 300 | 5,00 | 9,76 | 5,00 | 7,28 | 10,96 | 8,05 | 8,95 | 27,93 | | 27,69 | | | |
| 315 | 4,45 | 8,76 | 4,45 | 8,13 | 12,16 | 7,02 | 9,56 | 30,93 | 26,55 | 33,59 | | | |
| 355 | 5,12 | 9,56 | 5,12 | 9,24 | 15,52 | 8,05 | 18,40 | 36,91 | 35,21 | 37,86 | | | |
| 400 | 6,40 | 12,26 | 6,40 | 11,50 | 18,40 | 8,95 | 18,40 | 41,41 | 43,63 | 41,41 | | | |
| 450 | 7,21 | 13,74 | 7,99 | 13,49 | 25,09 | 10,86 | | 44,90 | 60,93 | 47,60 | | | |
| 500 | 9,01 | 15,48 | 9,01 | 14,48 | 26,49 | 11,00 | 22,49 | 52,75 | 58,51 | 50,89 | | | |
| 560 | 12,09 | 16,49 | 10,80 | 18,40 | 33,42 | 13,30 | | 70,52 | | 65,51 | | | |
| 600 | 11,47 | 19,16 | 11,50 | 22,24 | 35,81 | 15,52 | | 74,61 | | 68,41 | | | |
| 630 | 12,09 | 18,09 | 14,38 | 23,69 | 36,28 | 14,86 | | 74,61 | 107,66 | 55,80 | | | |
| 710 | 16,11 | | 16,39 | 85,03 | 70,88 | 19,07 | | 138,01 | | 65,28 | | | |
| 800 | 19,86 | | 22,36 | 85,03 | 72,80 | 24,81 | | 172,83 | 140,15 | 69,14 | | | |
| 900 | 33,86 | | 56,53 | 88,93 | 113,12 | 26,03 | | | | 88,50 | | | |
| 1000 | 36,16 | | 55,38 | 88,93 | 117,79 | 30,08 | | | | 92,46 | | | |
| 1120 | 43,76 | | 63,98 | 146,67 | 163,82 | 39,48 | | | | 123,36 | | | |
| 1250 | 47,44 | | 67,22 | 159,72 | 205,94 | 39,12 | | | | 217,31 | | | |

Vet cursief gedrukte diameters zijn aanbevolen en toegevoegde NEN-EN 1506 diameters en veelal voorradig.

1

2

3

4

5

6

7

8

9

10

11

12